



FITTING INSTRUCTIONS

Part Number: **3748020**

Product **DUAL CAB RACK MOUNTING KIT**

Description:

Suited to **HOLDEN COLORADO 2012 ON , ISUZU DMAX 2012 ON**
vehicle/s:

WARNING

ALSO, NOTE THE FOLLOWING:

- ◆ This product must be installed exactly as per these instructions using only the hardware supplied.
- ◆ In the event of damage to any cab rack component, contact your nearest authorised ARB stockist. Repairs or modifications must not be attempted.
- ◆ Do not use this product for any vehicle make or model, other than those specified by ARB.
- ◆ Do not remove labels.
- ◆ This product or its fixing must not be modified in any way.
- ◆ The installation of this product may require the use of specialized tools and/or techniques
- ◆ It is recommended that this product is only installed by trained personnel
- ◆ These instructions are correct as at the publication date. ARB Corporation Ltd. cannot be held responsible for the impact of any changes subsequently made by the vehicle manufacturer
- ◆ During installation, it is the duty of the installer to check correct operation/clearances of all components
- ◆ Work safely at all times
- ◆ Unless otherwise instructed, tighten fasteners to specified torque

ARB 4x4 ACCESSORIES



Head Office

Tel: +61 (3) 9761 6622

Fax: +61 (3) 9761 6807

sales@arb.com.au
sales@arb.com
exports@arb.com.au

www.arb.com.au

WARNING

NOTE THE FOLLOWING:

Your ARB Roof Rack has a maximum carrying capacity of 75kg. This load should not be exceeded and all loads must be tied down securely. If you have a cage with mesh fitted, secure the load to the main framing of the cage as well as the mesh.

It is important to follow the listed usage instructions;

- ◆ The vehicle owner's manual should be consulted prior to loading the roof rack as the manufacturer's recommended maximum load for the vehicle's roof may be less than the maximum load specified for the roof rack.
- ◆ Load must be evenly distributed and adequately secured.
- ◆ Any weight carried on the roof of the vehicle will adversely affect its handling, particularly in cornering or in a cross-wind, the vehicle should therefore be driven with increased discretion.
- ◆ Regularly check the tightness of the securing clamps and the security of the load.
- ◆ Attention is directed to statutory requirements regarding maximum permissible projections from vehicles.



All bolts should be checked prior to touring to ensure the rack is fastened correctly

FITTING REQUIREMENTS

REQUIRED TOOLS FOR FITMENT OF PRODUCT:

Metric Allen key set up to 6mm	Scissors
Non acidic silicon (neutral cure)	Sharp knife
Masking tape	Tin snips

HAVE AVAILABLE THESE SAFETY ITEMS WHEN FITTING PRODUCT:

Protective eyewear 	Hearing protection 
--	--

NOTE: 'WARNING' notes in the fitting procedure relate to OHS situations, where to avoid a potentially hazardous situation it is suggested that protective safety gear be worn or a safe work procedure be employed. If these notes and warnings are not heeded, injury may result.

FASTENER TORQUE SETTINGS:

SIZE	Torque Nm	Torque lbft
M6	9Nm	7lbft
M8	22Nm	16lbft
M10	44Nm	32lbft
M12	77Nm	57lbft

PARTS LISTING			
APPLICATION.	PART NO.	QTY	DESCRIPTION
MOUNTING BRACKETS TO ROOF	3759150R	1	Roof rack mount rail
	3759150L	1	Roof rack mount rail
	6151295	8	BHC screw M8 x 20mm S/S
	4581081	8	Washer flat M8 S/S
	4581094	8	Washer spring M8 S/S
	5846272	4	Roof rack rubber packer
	6781408	8	Tape double sided
AIR DEFLECTOR TO ROOF RACK	6522920	1	Air deflector
	6151300	3	Nut cage M6
	6151303	2	Nut cage M8
	6151256	3	Screw button M6 x 16
	4581304	3	Washer flat M6
	4581305	3	Washer spring M6 S/S
	6151295	2	BHC screw M8 x 20mm S/S
	4581081	2	Washer flat M8 S/S
	4581094	2	Washer spring M8 S/S
ROOF RACK TO MOUNTING BRACKET	3193522	4	Roof rack bolt plate
	6151184	8	SHC screw M8 x 30 S/S nylon patch
	4581081	8	Washer flat M8 S/S
	4581094	8	Washer spring M8 S/S

FITTING PROCEDURE



1. Unclip the exterior roof trim from both sides of the vehicle. Take care not to bend the trim, as it will be reused.



2. If the captive nuts in the roof are covered, carefully remove the covering using a knife.
3. Remove all of the double sided tape from both roof channels. Then clean the residual glue from the roof and the trim. It is recommended to use an adhesive cleaner for this task.

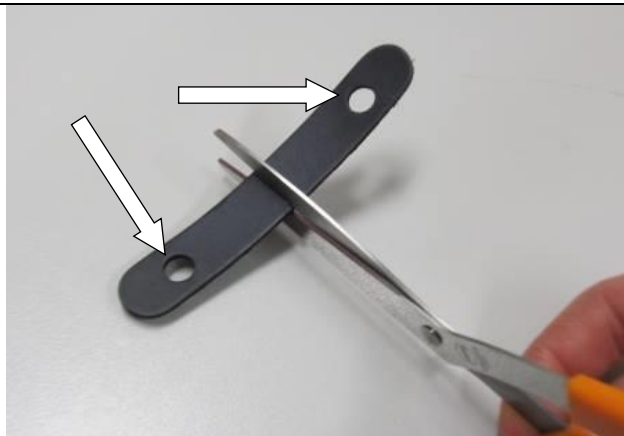

4. Cut the rubber mount pads in half and trim to suit mount plates as shown
5. Apply a small amount of silicon on both sides of the rubber packer, only at the holes. Also apply a small amount of silicon to the underside of heads of the M8 x 20 button head screws.



6. Apply protective tape as shown in the image and place the rubber packer on the vehicle roof first, and then loosely fit the mount bracket.

Note: the larger end of the bracket is positioned to the front of the vehicle (refer to next image for further clarification).

FITTING PROCEDURE



7. Now fasten and fully tighten brackets using 4 x M8 button head bolts, 4 x M8 spring washers and 4 x M8 flat washers.
8. Remove the protective tape.

 M8 - 22 Nm.



9. Using tin snips or similar (metal strip is inside rubber mould) cut the roof trim that was removed earlier at step 1 to fit neatly around the roof rack mounting brackets. There will be six pieces in total for the whole roof.
10. Apply double sided tape as shown and reattach the roof trim to fit around the rack mounting brackets.
11. Repeat on LHS

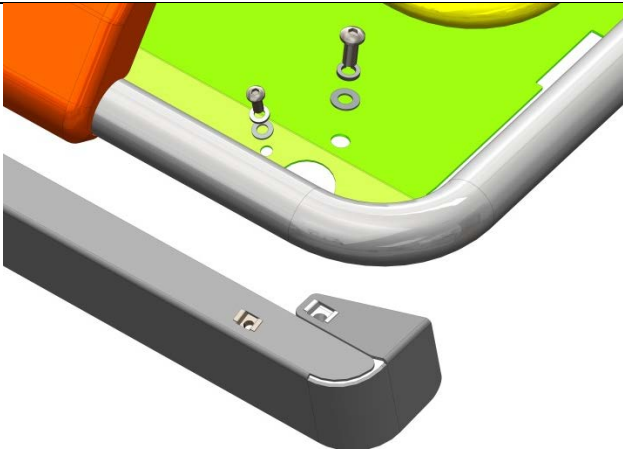

12. Fit 3 x M6 and 2 x M8 cage nuts to air deflector as shown. Secure to rack using M6 button head screw, M6 spring and flat washers, M8 button head screws, M8 spring washers and flat washers.

 M6 - 9 Nm.

 M8 - 22 Nm.

13. With the assistance of another person, lift the roof rack onto the vehicle making sure the aerial does not get caught under the rack and air deflector. Position evenly.



14. Fix the roof rack in place using eight M8 x 30mm socket head cap screws, M8 flat washers, M8 spring washers and four bolt plates. Centre rack and tighten all bolts to their specified torque.



M8 - 22 Nm.

FITTED PRODUCT

